

## Future Development

The Boggo Road Cross River Rail (CRR) Priority Development Area (PDA) came into effect on 4 November 2022. The scheme focuses on developments that enrich knowledge, technology, and health related uses in the area.

Economic Development Queensland is responsible for the long-term planning of the precinct. For more information on the Boggo Road Cross River Rail PDA, please visit the Department of State Development and Infrastructure website.

A permanent location for Outlook Park will be delivered as part of future development within the CRR PDA.

🌐 [www.statedevelopment.qld.gov.au](http://www.statedevelopment.qld.gov.au)

For more information  
on the Cross River  
Rail PDA areas



Future development site south of Boggo Road station

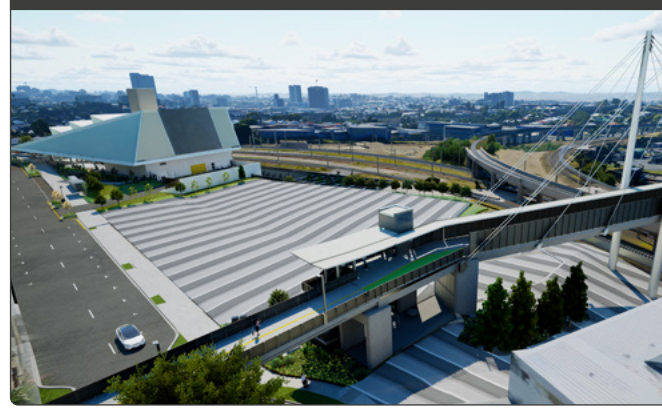

Stay up  
to date

Subscribe to receive  
construction updates at  
[crossriverrail.qld.gov.au](http://crossriverrail.qld.gov.au)



Or scan this  
QR code

## Construction update

Construction of the station buildings is underway. The Cross River Rail Tunnel & Stations team will continue to keep the community informed about construction activities.

## Legend

1. Canopy
2. Main station entrance
3. Lifts and escalators
4. Mezzanine level
5. Platform level

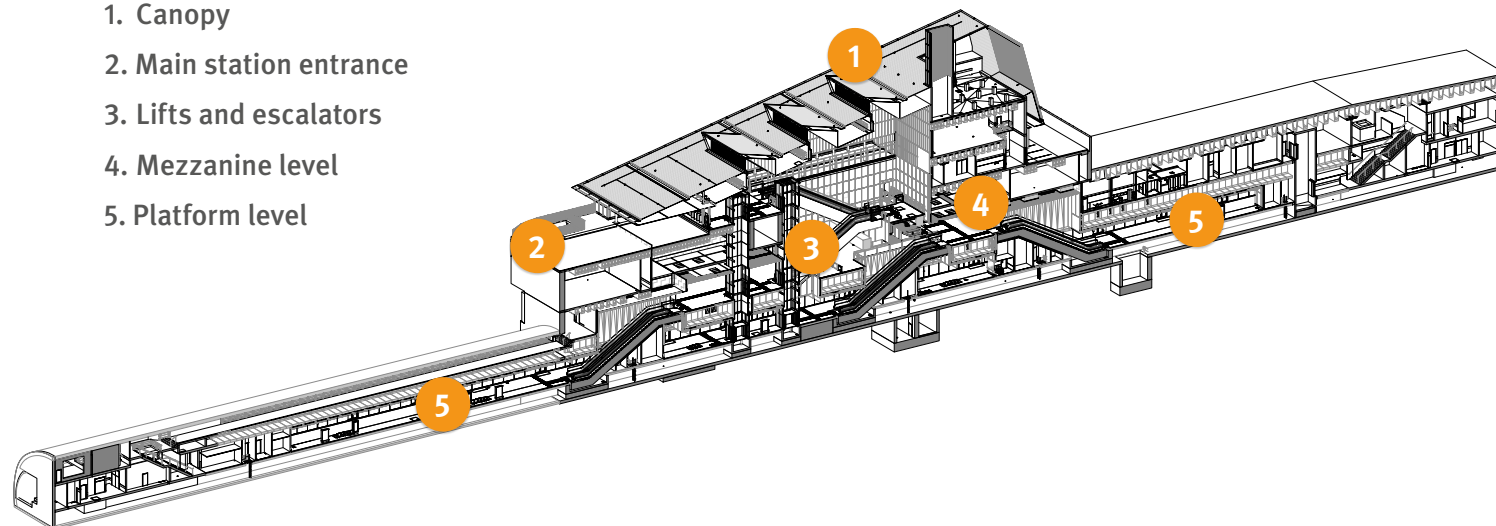

CROSSRIVERRAIL  
DELIVERY AUTHORITY

December 2025

# Boggo Road station

Boggo Road is set to become South East Queensland's second busiest transport interchange, seamlessly integrating and enhancing multiple transport links within Brisbane's rapidly growing inner-south health, science and education precinct.

## The new underground station

At Boggo Road, a striking, tiered roof structure extends beyond the building's perimeter to create a shaded pedestrian walkway along Joe Baker Street. With distinctive rows of horizontal glass louvers that allow natural light and ventilation to flow into the station concourse and down to platform level. Inside the station, mechanical and electrical support systems are being seamlessly integrated into the main station structure, to help the station concourse maintain a clean and cohesive architectural design.

From this open and generous concourse space, banks of escalators descend down to a 220-metre long mezzanine level, from which customers will access the station platform.

Main station entrance



## Station plaza and integration with existing services

The Boggo Road precinct plaza will feature landscaping designed to complement the scale and distinctive form of the station building canopy.

From the station plaza, customers will have a clear line of sight through to fare gates and the lifts or escalators that will take passengers down to the new underground platforms.

A covered walkway will also provide weather protection for passengers transferring between the new underground station and existing bus and rail surface platforms.

Station entry interior



All the images in this document are digital illustrations – Not final for design or build.



1800 010 875



[info@crossriverrail.qld.gov.au](mailto:info@crossriverrail.qld.gov.au)



[crossriverrail.qld.gov.au](http://crossriverrail.qld.gov.au)



If you need an interpreter to assist you in understanding this document, please call the Translating and Interpreting Service (TIS National) on 131 450 and request to be transferred to Multicultural Affairs Queensland on 13 QGOV (13 74 68)

CROSSRIVERRAIL  
DELIVERY AUTHORITY



CROSSRIVERRAIL  
DELIVERY AUTHORITY





Aerial view of Yamma Bridge and Boggo Road station



## Yamma bridge

The new pedestrian and cycle bridge being constructed at Boggo Road has been named Yamma Bridge (pronounced Yumma).

Yamma means ‘arm’ in the Yagara language; and has been selected to represent the way in which this new bridge reaches over the rail line and connects the Boggo Road bus and train services with the Princess Alexandra Hospital and wider health, science and education precinct.

The bridge is approximately 480m long and features a 43m high cable-stay spire.

## Public art

Brisbane’s four new underground stations will feature no fewer than 15 separate artworks by Queensland’s most renowned Indigenous artists, creating a celebration of the state’s cultural heritage not seen anywhere else.

At Boggo Road, a stepped rest area will feature carvings detailing native Indigenous flora once found throughout Brisbane, inviting travellers to reflect on their own relationships with nature.

Inside the station, a large-scale mural talks to the many winding rivers of Queensland, while at platform level, native flowers are reimaged to evoke traditional sources of nutrition and medicine.

# CROSSRIVERRAIL STATION ART



Scan to learn more about the art that will feature in Cross River Rail’s four new underground stations.



Main station escalator wall artwork  
*Ataga Ulumu* by Teho Ropeyarn



Plaza artwork  
*Reflection* by Tamika Grant-Iramu



Platform level artwork  
*Apa kausal* by Brian Robinson

