

# Works Notice

August 2021

## Trackside signalling work in August

Hitachi Rail is continuing construction work along the Shorncliffe Line to deliver Brisbane's new railway signalling system as part of the Cross River Rail Project.

### Details of work

During **August** construction work will continue in the rail corridor at sites from **Northgate to Shorncliffe stations**.

The majority of works will occur between **6:00am to 6:00pm, Monday to Friday**. Activities will include excavation, trenching, concreting, cabling works, and installing signalling equipment and equipment housing.

To facilitate works, some **changes to station car parks will be necessary**, including at Sandgate and Deagon. Please see local signage for details.

To ensure the safety of workers and the community, some activities will be **undertaken during track closures (where buses will replace trains) outside of normal construction hours**, weather permitting:

Date and hours of work	Location	Type of work
From 11pm Friday 30 July to 2.30am Monday 1 August	Nudgee to Shorncliffe	Cable hauling and cable route installation
	Kennerley St crossing, Sandgate station (road closure)	Services investigation and under road boring for cable routes
	Sandgate and Shorncliffe stations	Excavation of pits Installation of signalling housing and equipment (Sandgate only)
	Boondall station	Excavation of under track crossing
	Palm Avenue crossing, Sandgate	Realignment of trackside cabinets and under track crossing excavation
From 11pm Friday 6 August to 5am Monday 9 August	Palm Avenue crossing, Sandgate (road closure)	Services investigation and under road boring for cable routes
From 11pm Friday 13 August to 5am Monday 16 August	Adams St crossing, Deagon including Smith Street (road closure)	Services investigation and under road boring for cable routes
Monday 16 August - Friday 20 August between 10.30pm and 4.00am	Banyo to Shorncliffe	Modifications to existing signalling housing and equipment Cable hauling
Saturday 21 August - Monday 23 August	Sandgate to Shorncliffe stations	Queensland Rail track maintenance Trackside signalling equipment checks
Saturday 28 August - Sunday 29 August	Nudgee to Sandgate stations	Energising of new equipment (Sandgate station) Cable hauling



1800 010 875



etcsinfo@hitachirail.com



crossriverrail.qld.gov.au



If you need an interpreter to assist you in understanding this document, please call the Translating and Interpreting Service (TIS National) on 131 450 and request to be transferred to Multicultural Affairs Queensland on 13 QGOV (13 74 68)



There will also be changes to traffic conditions with scheduled closures and traffic control including:

Location	Date and details
Kennerley Street, Sandgate	11pm Friday 30 July – 5am Monday 2 August Full road closure. Detours in place via Adams Street, Deagon.
Curlew Street, Sandgate	Day works – Tuesday 3 August – Thursday 5 August Hold and release traffic control. Parts of the Cobb Street car park will also be closed.
Palm Avenue, Sandgate	11pm Friday 6 August – 5am Monday 9 August Full road closure. Detours in place via Pier Avenue, Sunday Street, Allpass Parade and Sinbad Street
Adams and Smith streets, Deagon	11pm Friday 13 August – 5am Monday 16 August Full road closure. Detours in place via Kennerley Street, Sandgate.

### Kennerley Street, Sandgate

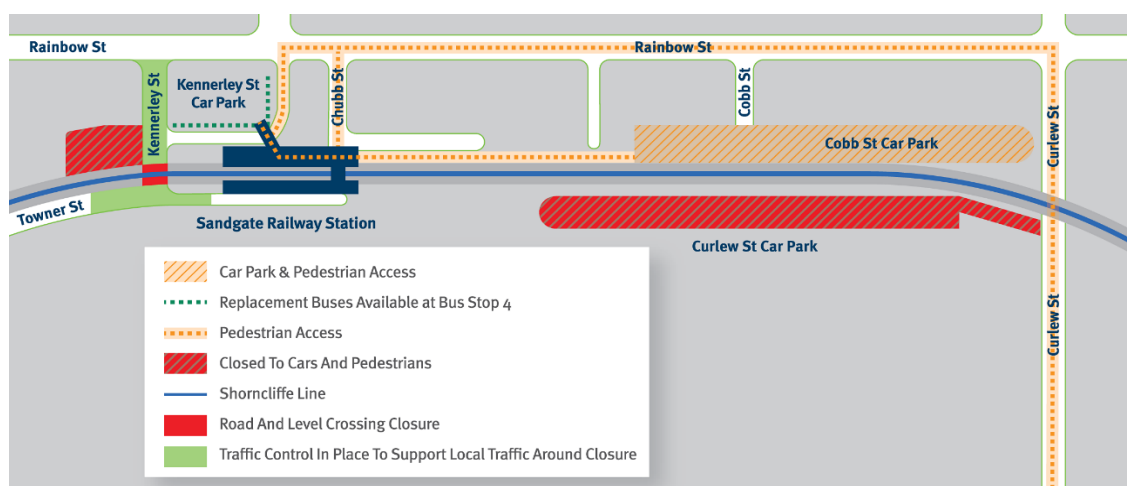

### What to expect if you live alongside the rail corridor

Residents along the rail corridor may see and hear dust and noise associated with the use of machinery and equipment (including excavators, skid steer loaders, concrete trucks and pumps, and vacuum trucks), and mobile lighting towers in work areas during night works.

To minimise impacts: environmental controls will manage noise and dust (including noise minimisation practices after hours), lighting towers will be directed away from residential properties, where practical.

### What to expect if you're a rail customer

Cross River Rail will transform how we travel to, from and through Brisbane in the future. And while that means the whole of South East Queensland can start looking forward to the benefits of Cross River Rail, right now it means changes to the way you travel. Sign up to receive updates and use the TransLink Journey Planner at [translink.com.au](https://translink.com.au), call 13 12 30 or download the MyTransLink app.

### Subscribe to receive updates

To keep up-to-date with work in your area, please subscribe to electronic updates at [crossriversrail.qld.gov.au](https://crossriversrail.qld.gov.au) and select **ETCS**.



1800 010 875



[etcsinfo@hitachirail.com](mailto:etcsinfo@hitachirail.com)



[crossriversrail.qld.gov.au](https://crossriversrail.qld.gov.au)



If you need an interpreter to assist you in understanding this document, please call the Translating and Interpreting Service (TIS National) on 131 450 and request to be transferred to Multicultural Affairs Queensland on 13 QGOV (13 74 68)

