

# Yeronga station concept design

As part of the Cross River Rail Project, six stations from Fairfield to Salisbury will be upgraded to improve access and functionality.



Yeronga

Fairfield

Yeronga

Yeerongpilly

Moorooka

Rocklea

Salisbury



Queensland  
Government

## Lake Street entrance



Concept only – subject to change

## Station features

Features of the Yeronga station include:

- An additional (third) platform
- A new station building
- An upgrade to the existing platforms
- New overpass and vertical transport system including three lifts and stairs
- Provision for accessible parking within the car park
- Provision for Kiss 'n' Ride car parking
- Improved access to the platforms.

## Current status

Early works are continuing including geotechnical investigations, survey, installation of overhead electrical structures and preparing the detailed design for construction. Major construction at Yeronga station is scheduled to start in late 2020.

## Project information

Subscribing to receive Project Updates is a convenient way to obtain information about the project and work happening in your area. To subscribe, simply visit the Cross River Rail website and look for the subscription area at the bottom of every page.

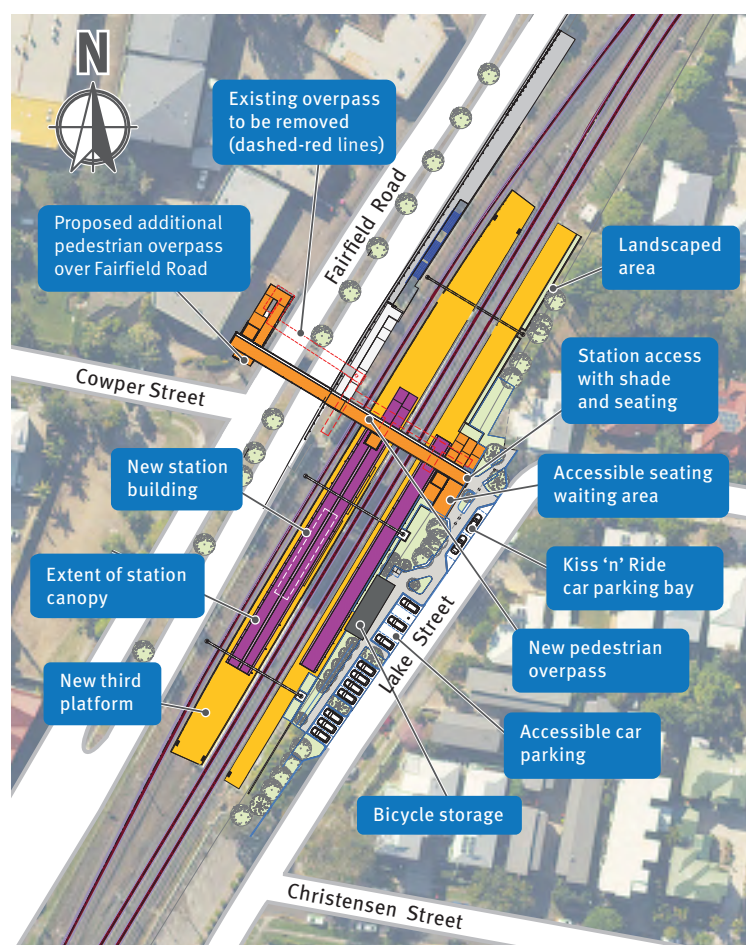

## Lake Street entrance



Concept only – subject to change

## Contact us

- 1800 010 875  
[info@unityalliance.com.au](mailto:info@unityalliance.com.au)  
[crossrerrail.qld.gov.au](http://crossrerrail.qld.gov.au)



If you need an interpreter to assist you in understanding this document, please call the Translating and Interpreting Service (TIS National) on 131 450 and request to be transferred to Multicultural Affairs Queensland on 13 QGOV (13 74 68)

